

PNEUMATRON

www.pneumatron.co.za

sales01@pneumatron.co.za

PXD 5VDC Electric Ball Valve Series ELECTRIC MOTOR - 2/2 Way BRASS BALL VALVE

PLEASE NOTE

There are Electronic Boards inside these valve actuators and therefore they cannot be mounted on vibrating surfaces or pipes. Mount them on a fixed surface and connect to the generator with rubber hoses.

SPECIFICATIONS:

Media: Water & compatible chemicals

Body & Seal: Brass & EPDM

Ball Seat: PTFE (Teflon)

Ambient temp: -20°C < t < 45°C

Media temp: 2 to 95°C

Voltages: 5VDC - Swop Polarity Type (W21)

Actuator Protection: IP40

Operating power/time: ~100mA for +/-3 seconds

FULL Close and Open Time: +/- 3 seconds



PXD Electric Ball Valve is tested in for a minimum of 30 cycles before being released for sale.

Port (BSP)	Orifice size (mm)	Function	Pressure Range	Wiring Diagram	Max Power	Part number
3/4"	15	Detent	0 to 10 Bar	W21 - wiring	<2W (5VDC)	PXD15BH15S06-W21D05

Wiring options:

W21 wiring - Swop Polarity Control (Detent) 5VDC

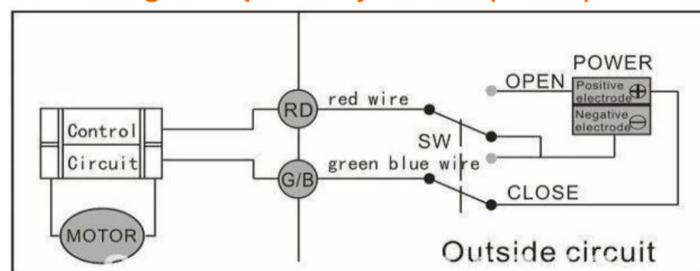

SW - Switch
BL - Blue
WT - White
YW - Yellow
RD - Red
GR - Green
BK - Black
GY - Gray

Connecting SW and OPEN , valve opens, the actuator automatically powers off when valve is completely open.

Connecting SW and CLOSE, valve closes, the actuator automatically powers off when valve is completely closed.

PNEUMATRON

www.pneumatron.co.za

sales01@pneumatron.co.za

PXD 5VDC Electric Ball Valve Series ELECTRIC MOTOR - 2/2 Way BRASS BALL VALVE

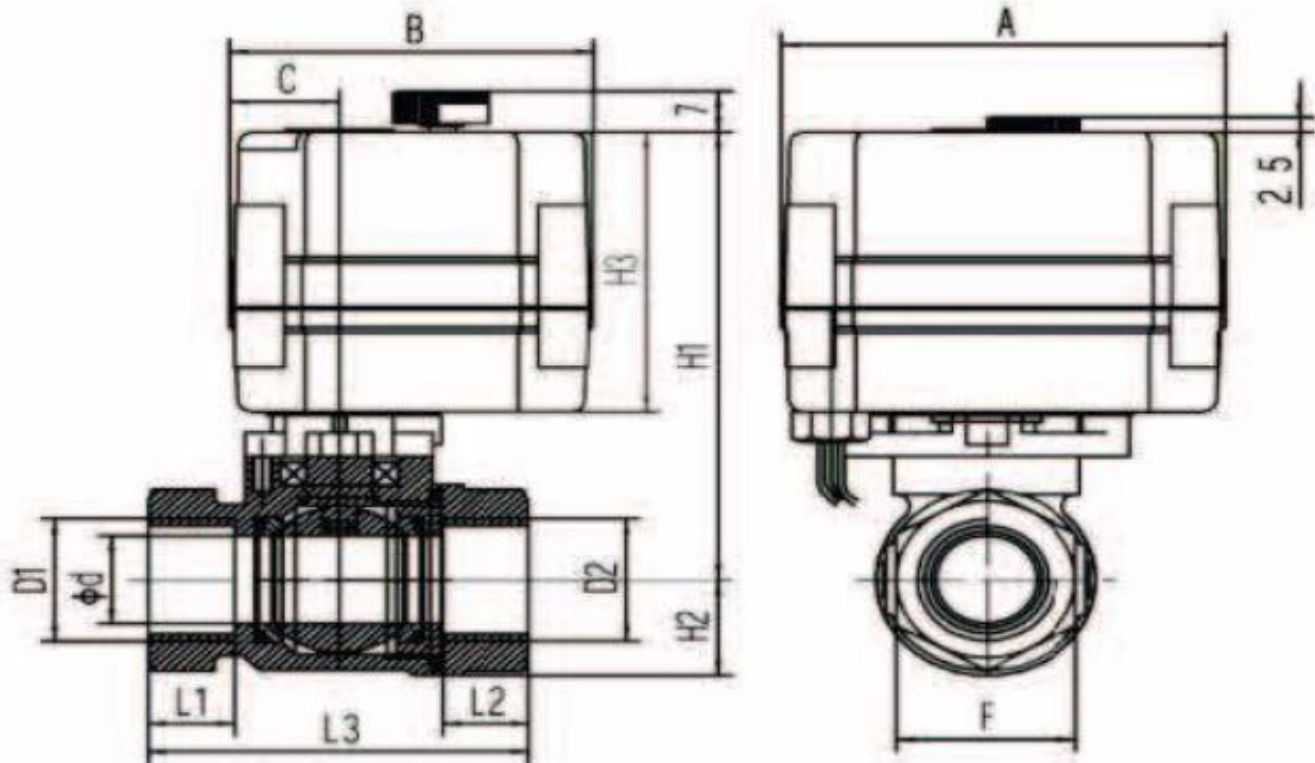

BODY DIMENSION CODE (Size in mm)

Valve body	D1/D2	L1	L2	L3	F	H1	H2	H3	B	A
PXD15BH15S06-W21D05	3/4" (15mm)	10	10	61	30	72	22	50	52	62

VALVE INSTALLATION INSTRUCTIONS

1. Please note the IP rating of this valve, it is not fully waterproof.
2. The valve label will indicate the valve body material and the seal material. Never apply incompatible fluids or gasses with the body and seal material.